

READ CAREFULLY BEFORE USING YOUR DOLPHIN DYNAMIC PRO ROBOT POOL CLEANER

INSTALLATION

The CADDY and power supply [1 page-7] should be positioned so that the DOLPHIN can reach all the corners of the swimming pool and must be at a minimum distance of 3 meters [10 Ft.] from the edge of the pool. For best operation of the DOLPHIN Swivel cable [16 page-7] leave excess cable rolled out side of the pool [Fig A+B].

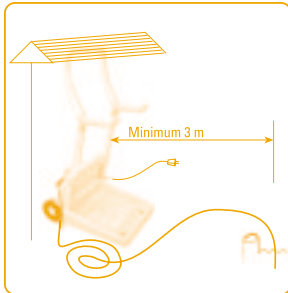

Fig A

THE POWER SUPPLY

Factory-wired for either 100V, 115V or 230V mains supply, the voltage rating should be checked before connection.

Ensure that the mains/line outlet is protected by a ground fault interruptor [GFI] or earth leakage interruptor [ELI].

Caution: When working, the power supply should be placed in the shade.

Use only the original DOLPHIN power supply.

At the front section there are lights that indicate when the DOLPHIN is operating or when the filter bag needs to be cleaned or washed.

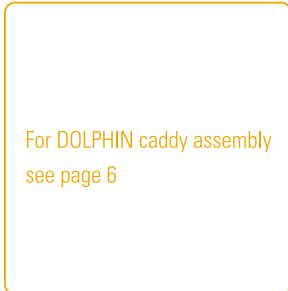

Fig B



Will lit up when switching ON power supply.
Will flash at initial performance of self test.



Will remain unlit during normal operation.
Will lit up and flash when the filter bag fills up and needs cleaning.
Will remain lit when the filter bag is clogged and needs washing.

Note: The filter bag light is a recommendation. No harm can be done to the DOLPHIN if lit. The DOLPHIN pool cleaner and power supply have been designed for safe, maintenance-free outdoor use.

DOLPHIN CADDY ASSEMBLY

Please follow these instructions and refer to the attached diagram when assembling your CADDY.

[Fig B, page-6].

• Connect the wheel assembly [c-1 page-6], while making sure it is centered, with a washer [c-2 page-6] on each side, inserting it with a sharp knock into the groove at the bottom of the base.

• Insert the two straight pieces of pipe [c-3 page-6] into the aperture in the tower until they "click" into the clips in the studs on the base of the tower [c-4 page-6].

Note: There are 2 small holes at each end of the pipe.

The holes which are located at a shorter distance from the edge of the pipe must be inserted into the base.

• Insert the top of the handle with the hooks [c-5 page-6] until it "clicks" into the pipes.

• Fasten the plastic power supply [c-6 page-6] to the CADDY tower by fitting the slots in the back of the power supply's handle over the "T" pins in the tower, and pressing down firmly until the base of the power supply reaches the holes in tower base.

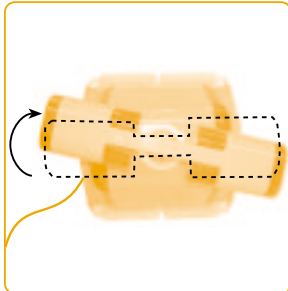

Fig C

HANDLE

The DOLPHIN features an adjustable handle [2 page-7] that is fitted into slots on each side of the DOLPHIN body. After the unpacking of the DOLPHIN from its carton box, the handle must be locked in a diagonal position across the top of the DOLPHIN body in order to ensure optimum cleaning results [Fig C].

Press downwards on each yellow latch [3 page-7] to move each handle arm. For efficient **Water Line** cleaning program, position the handle diagonally exactly as shown in [Fig D].

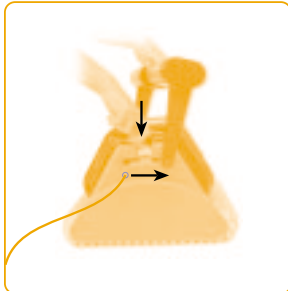

Fig D

OPERATION

Uncoil cable and connect to the DOLPHIN power supply. Release minimal required floating cable length, ensuring proper pool coverage.

Place cable and the DOLPHIN in pool, gently rock the DOLPHIN from side to side releasing trapped air until the DOLPHIN sinks slowly to the pool bottom [Fig E].

Plug the power supply mains plug into a socket protected by a ground fault circuit interrupter.

Warning! Do not operate the DOLPHIN out of the water. This may result in extensive damage to the pump motor seals, thus invalidating the warranty.

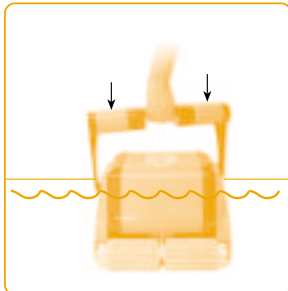

Fig E

Switch the power supply on and let the DOLPHIN work its wonders!

Warning! DO NOT ENTER THE SWIMMING POOL WHILE THE DOLPHIN IS IN OPERATION.

CLEANING MODES

The DOLPHIN DYNAMIC PRO model offers two modes of operation - AUTOMATIC or REMOTE CONTROL. The DOLPHIN will work in AUTOMATIC mode unless changed to REMOTE CONTROL mode, through the REMOTE CONTROL UNIT [R.C.U.].

REMOTE CONTROL MODE

In REMOTE CONTROL mode, you can manoeuvre the DOLPHIN to give special attention to certain areas of the pool.

Move the joystick in the direction you desire the DOLPHIN to clean.

Note: If joystick is not touched for 2 minutes the R.C.U. will switch off and the DOLPHIN will enter AUTOMATIC CLEANING mode.

AUTOMATIC CLEANING MODE

In AUTOMATIC CLEANING mode the DOLPHIN calculates its own cleaning path.

To customize the DOLPHIN cleaning program to suit your pool you should adjust parameters.

Once set, most of the parameters will remain in the DOLPHIN memory until modified.

REMOTE CONTROL UNIT [R.C.U.]

The R.C.U. is splash-proof only.

This R.C.U. is equipped with a digital screen, soft touch buttons and a joystick for manual operation.

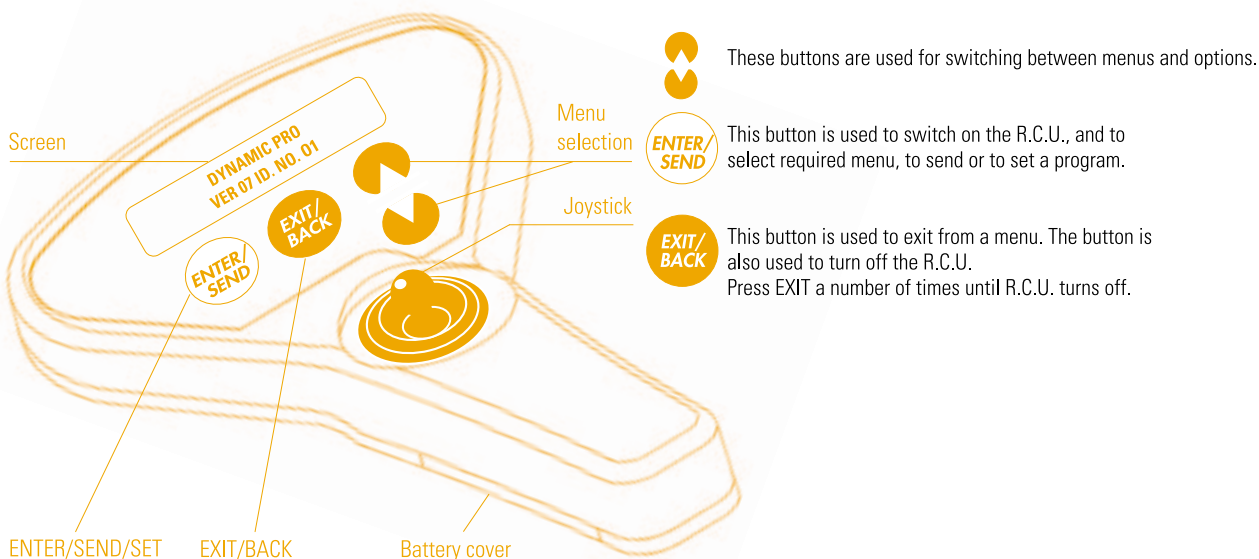

DESCRIPTION AND USE OF MENUS AND CLEANING PROGRAMS

Regular - The default floor and walls cleaning program.

Ultra Clean - Slower movement for special thorough cleaning.

Water Line - For special attention to walls and water line.

Note: For best results, remember to position the handle as shown in Fig D.

Laps pool - Suitable for this specific type of pool - narrow and long.

Climbing - This option controls the frequency of wall climbing eg: at which frequency the DOLPHIN should climb on the walls.

Cycle time - Choose the most suitable cycle time.

Pool length - Program the pool length.

Note: If you choose a **Laps Pool** cleaning mode, set the pool length after setting the mode.

If you choose cleaning modes of **Water Line** Cleaning or **Ultra Cleaning**, these parameters will not remain in the DOLPHIN memory.

The DOLPHIN will automatically revert to the default mode of either **Regular** Cleaning or **Laps pool** Cleaning.

Ultra clean mode can be selected from **Regular** mode only.

BATTERY REPLACEMENT

If the message "Low Battery" appears on the RCU screen:

- Open the battery cover.
- Remove all used batteries from the R.C.U.
- Place two 1.5 V AAA batteries into the R.C.U. as shown in the drawing inside the battery housing.
- Close the battery cover.

If you are not using your REMOTE CONTROL UNIT for more than 6 months - remove batteries.

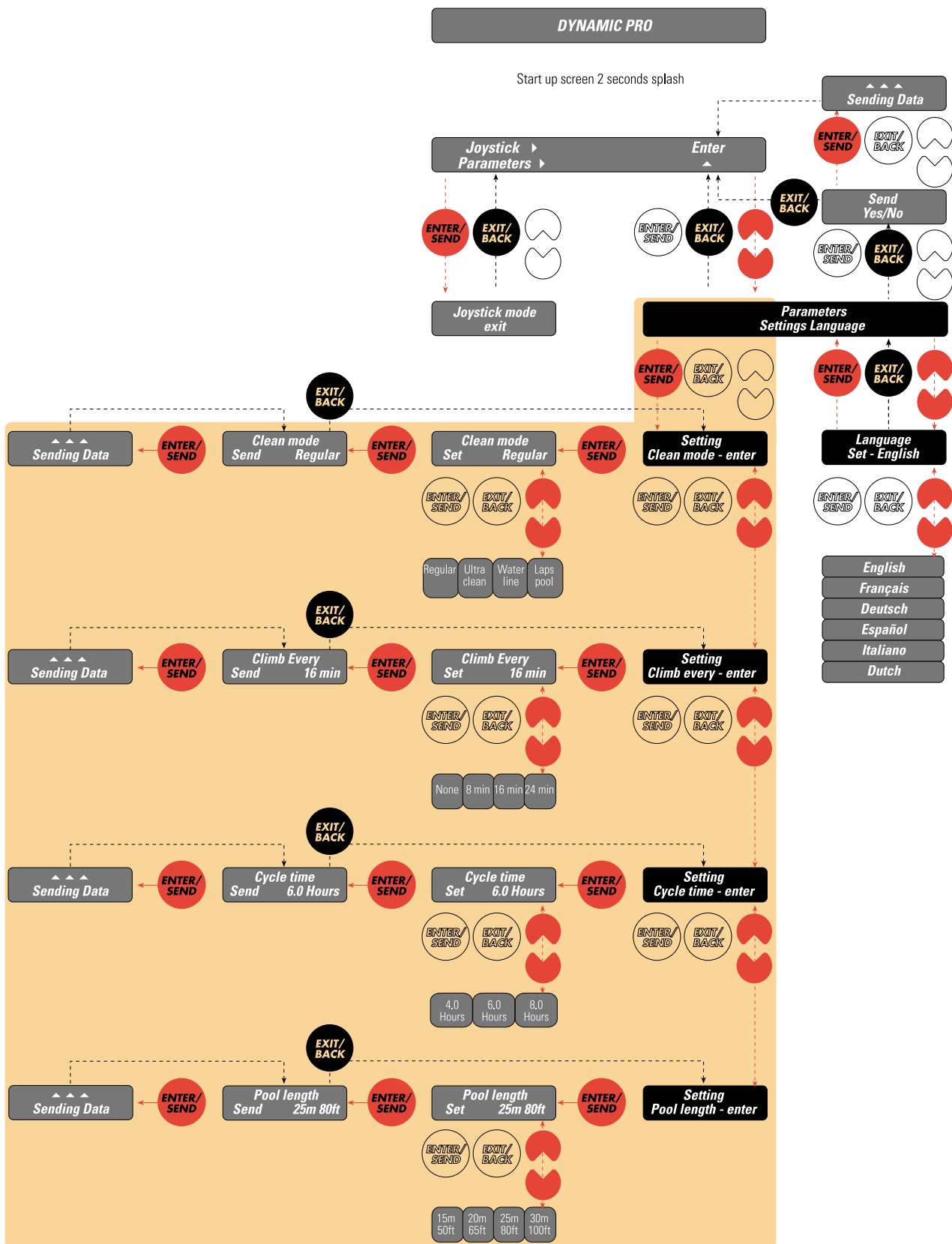

Note: If R.C.U. is not operated the DOLPHIN will enter AUTOMATIC CLEANING mode according to the last set of parameters used.

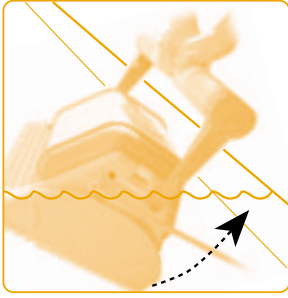

Fig
F

AUTOMATIC SHUT DOWN

The DOLPHIN will automatically shut down after the work cycle. Should another cycle be required, switch off the power supply for at least 30 seconds before restarting.

SWITCH OFF THE POWER SUPPLY BEFORE REMOVING THE DOLPHIN FROM THE POOL.

Caution: Surges and interruptions to electric power may cause the DOLPHIN to restart.

After the cycle time is completed:

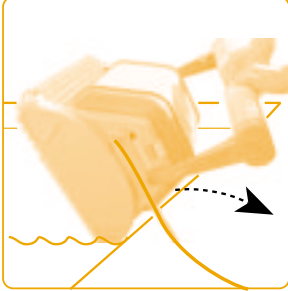

Fig
G

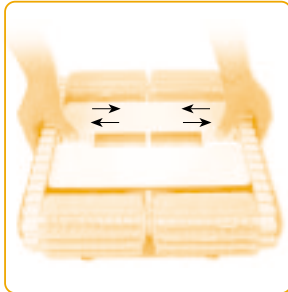

Fig
H



Fig
I

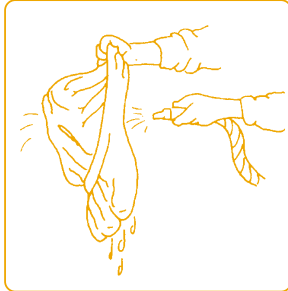

Fig
J

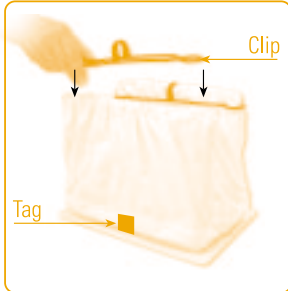

Fig
K

- **SWITCH OFF the power supply.**
- Pull the DOLPHIN to the surface by gently pulling the cable.
- Grab the handle and turn the DOLPHIN so that one of the brushes is against the pool wall [Fig. F].
- Lift the DOLPHIN out of the water by the handle – NOT BY THE CABLE.
- By pulling on the handle (NOT THE CABLE) lever the DOLPHIN over the pool edge, till it is lying on its side [Fig. G].
- Place the DOLPHIN upside down, release the 2 locking clips [5 page-7] [Fig. H] and remove the bottom lid assembly [6 page-7] [Fig. I].
- Remove the 2 filter bag clips [7 page-7] and the filter bag [8 page-7].
- Turn the filter bag inside out and wash thoroughly with a garden hose [Fig. J].
- The bag may be laundered using a regular synthetics cycle. This should be done at least once every 2 months.
- Remove the inlet cover [9 page-7] by gently pulling it upwards.
- Remove the inlet flaps [10 page-7].
- Clean the inlet flaps, the cover and under the locking clips.
- Reinstall the flaps and the inlet cover.
- Replace the filter bag with the tag on the outside positioned centrally along the length side of the bottom lid [Fig. K].
- Stretch the elastic trim of the bag over the 2 metal frames and over the white lip of the bottom lid.
- Gather all the excess filter material into the center of the metal frames.
- Gather the material along the top of the frames so that the corners of the bag are adjacent to the corners of the frames.
- Install a black filter bag clip over the top of the frames [Fig. K].
- Install the bottom lid assembly in the body and lock it in place.

PERIODICAL REMOVAL OF DEBRIS FROM THE MOVING PARTS

Warning! DISCONNECT MAINS BEFORE REMOVING IMPELLER TUBE [13 page-7].

The impeller can be cleaned by twisting and removing the impeller tube **[Fig.L]**.

Remove debris or hair that has clogged the impeller **[14 page-7]**.

The impeller can be unscrewed by means of a Philips screwdriver.

Remove the debris that has accumulated between tracks **[12 page-7]** and wheels **[11 page-7]**.



Fig
L

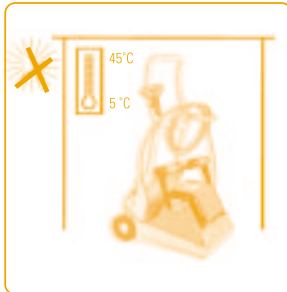

Fig
M

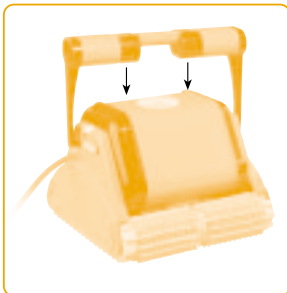

Fig
N

HELPFUL TIPS

- Clean filter bag whenever you remove the DOLPHIN from the pool.
- A dirty bag can become dry and unusable.
- Check PH level of pool water [optimally 7.0 - 7.2].
- Check water temperature [12° C - 32° C].
- Check that the brushes **[15 page-7]** are in good condition.
- Always switch the power supply "off", wait 30 seconds and switch "on" again to start a new cleaning cycle.
- Store the DOLPHIN upright on the caddy - not on its brushes - in the shade and at a temperature of between 5° C - 45° C. Coil the cable loosely around the caddy hooks **[Fig M]**.
- Wonder brushes or combined brushes should be kept wet at all times even when stored for a long period of time.
- When first used the DOLPHIN may climb too high and suck in air when it reaches the waterline. If so, remove the handle floats **[17 page-7]** by pushing them downward **[Fig N]**.

GENERAL SPECIFICATIONS

Calculated Ground Speed	900 m/hr
Calculated Scanning Rate	350 m ² /hr
Suction Rate [self controlled]	18,000 l/hr
Weight [w/o cable]	10.7 kg

Power Supply

Input Voltage	100 VAC / 115 VAC / 230 VAC
Output Voltage	30 VDC - nominal
Rated output	230 VAC - 150 W / 115 VAC - 150 W

These specifications may vary for different swimming pools and for the various electrical configurations.

Although the DOLPHIN has been tested in a wide range of swimming pools, MAYTRONICS cannot accept responsibility if the DOLPHIN is not entirely suitable for any particular swimming pool.

Note: The sealed motor unit and the DOLPHIN power supply contain no user-serviceable parts. Opening these units will automatically invalidate your warranty.

The manufacturer reserves the right to change these specifications without prior notice.
U.S. Patent No. 4168557. S.A. Patent No. 76/7474. AUST Patent No. 509698.

DOLPHIN CADDY ASSEMBLY

Fig
B

**ASSEMBLY
POWER SUPPLY
ONTO CADDY**

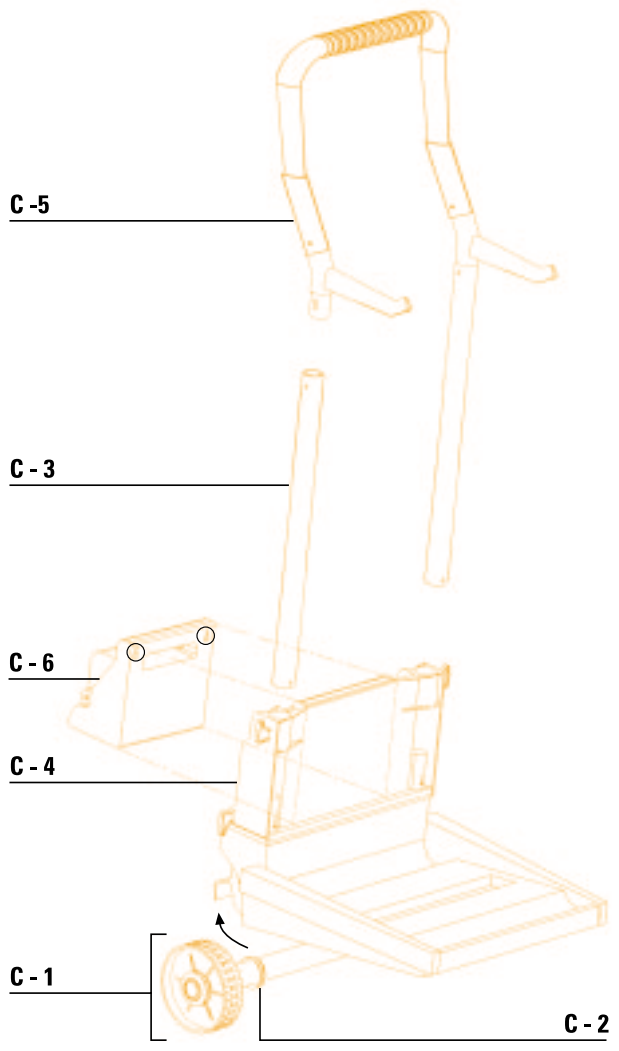
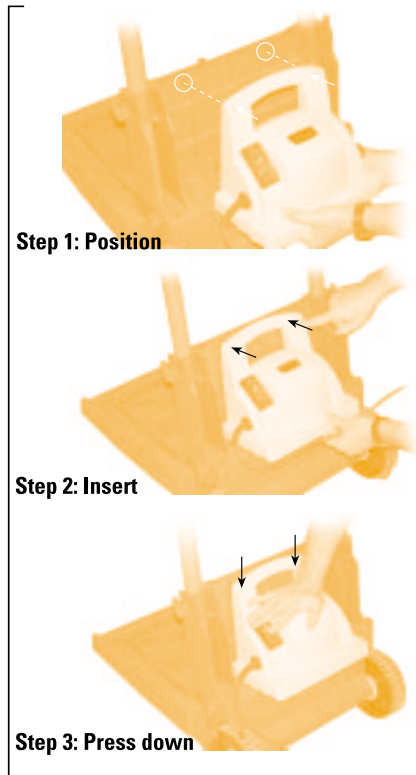

DOLPHIN ASSEMBLY

